

LAKE FRONT PROPERTY FOR LEASE



1-775-315-4314



LISTING INFORMATION

- Centralized lake front office and retail space, available now
- Total space available: 41,223 SF
- First level space:
 - 1,100 Leased
 - Suite 100 - 3,821 SF available
 - Suite 120 - 1,748 SF available
 - Suite 134 - 5,000 SF available
 - Suite 158 - 3,605 SF available
 - Suite 157 - 1,174 SF available
 - Suite 163 - 836 SF available
- Second level space:
 - Suite 210 - 1,392 SF available
 - Suite 240 - 1,243 SF available
 - Suite 254 - 12,050 SF available
- Lease rate: \$12.00/SF NNN

FEATURES

- Mid-city location between Eagle and downtown Boise
- Beautiful lakeside location
- Close to residential, restaurants and retail

DEMOGRAPHICS

Year: 2006	1 mile	3 mile	5 mile
Population	10,636	80,853	169,960
Ave. income	\$71,281	\$70,785	\$68,638

CONTACTS

Jeffrey Lowden 310 - 502 - 5703
Justin Greenberg 310 - 717 - 6015

"We provide a serene, centrally located office community that puts you and your clients at ease."

- Jeffrey Lowden, The Waterfront

The Waterfront Main Floor - Retail Space

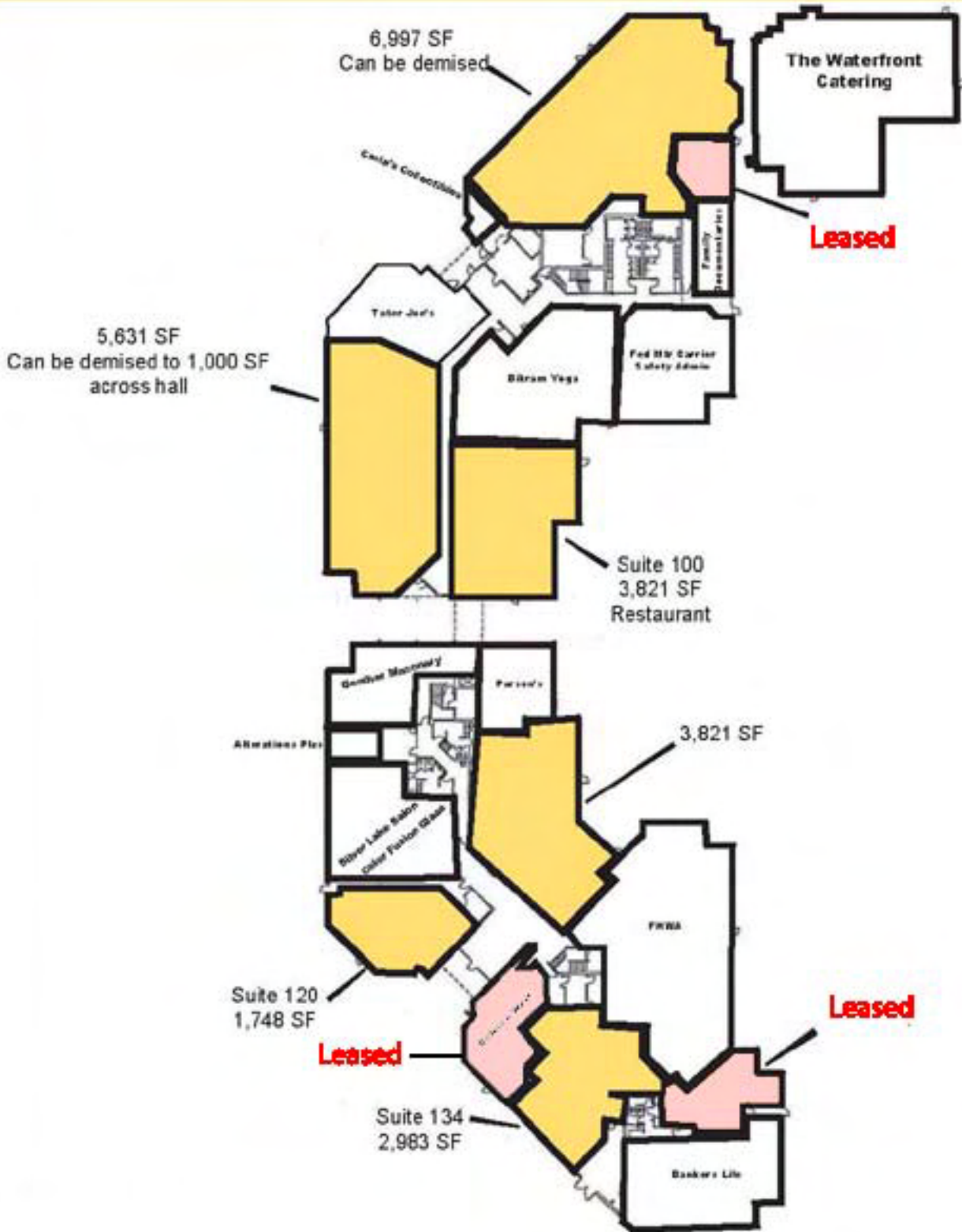

The Waterfront

Second Floor - Office Space

